



2nd Local Concerns Meeting For Main Street Safe Routes to School (SRTS) at Pollard Elementary

August 1, 2016



Hoyle, Tanner
& Associates, Inc.

Meeting Agenda & Goals

- Project Background
- Purpose & Need
- Previous Alternatives
- Preferred Alternative
- Project Funding
- Proposed Project Schedule
- Next Steps

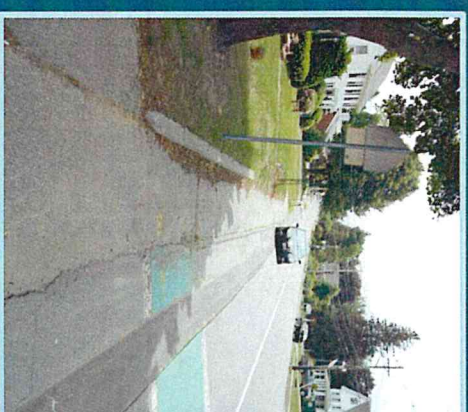

Project Background

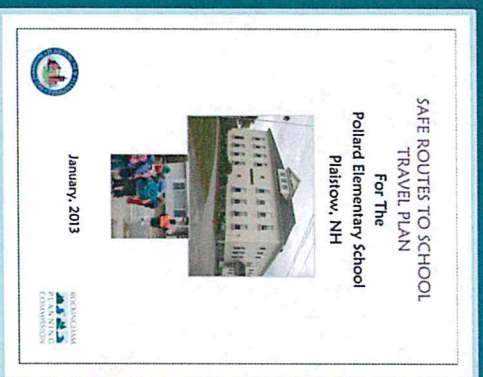
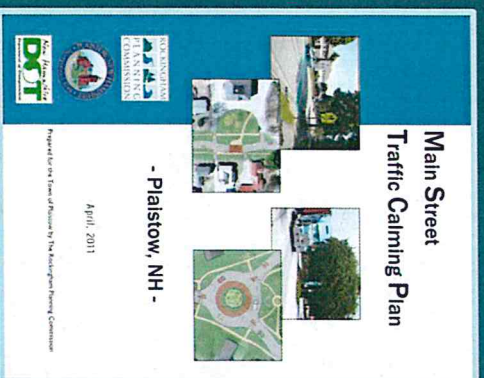

- Background
- "Main Street Traffic Calming Study"
- "Historic Village District Charrette"
- Travel Plan & Conceptual Design
- Local Concerns Meeting (May 2016)

Purpose & Need

- Public Comments
 - Speed Reduction & Enforcement
 - Crossing Visibility on Elm Street
 - Slip Lane Closure
 - Sight Distance at Elm Street
 - Shoulder Width Reduction
 - Gateway Signage



Purpose & Need

To improve pedestrian safety and mobility in Historic Plaistow Village Center while creating a "Sense of Place" through infrastructure & landscaping improvements which will reduce motorist speeds and limit cut-through traffic.

Previous Alternatives

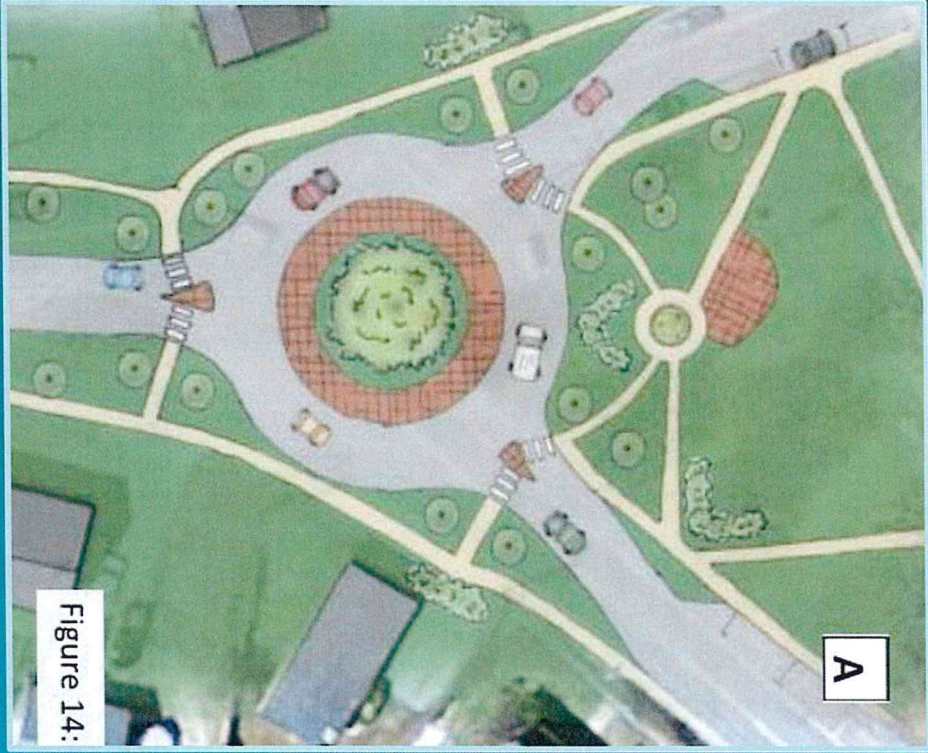
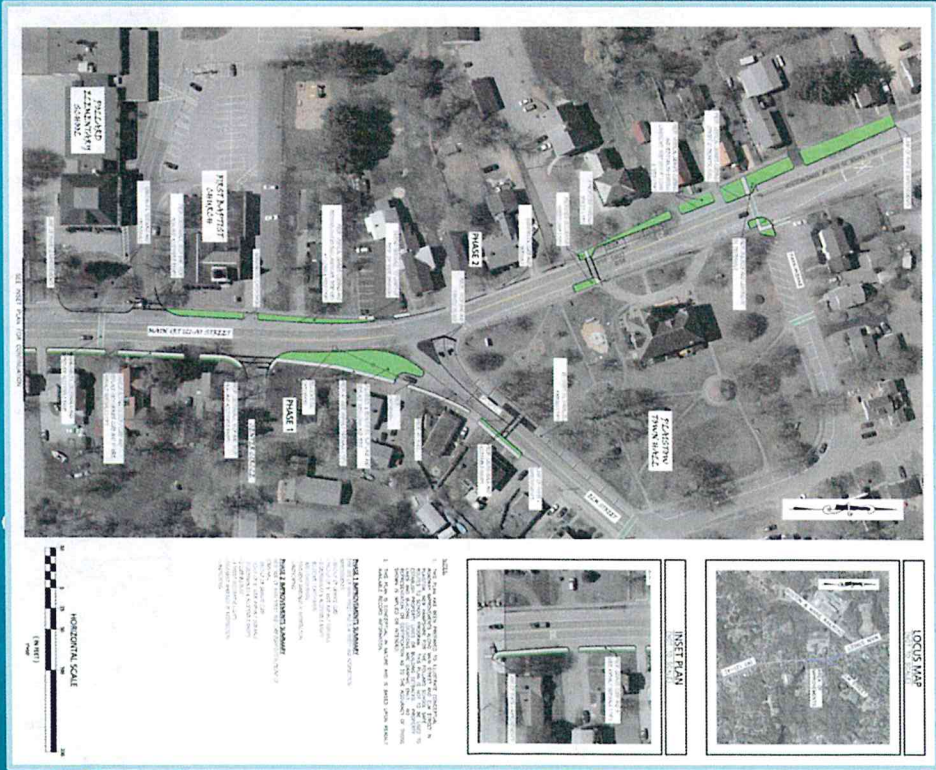
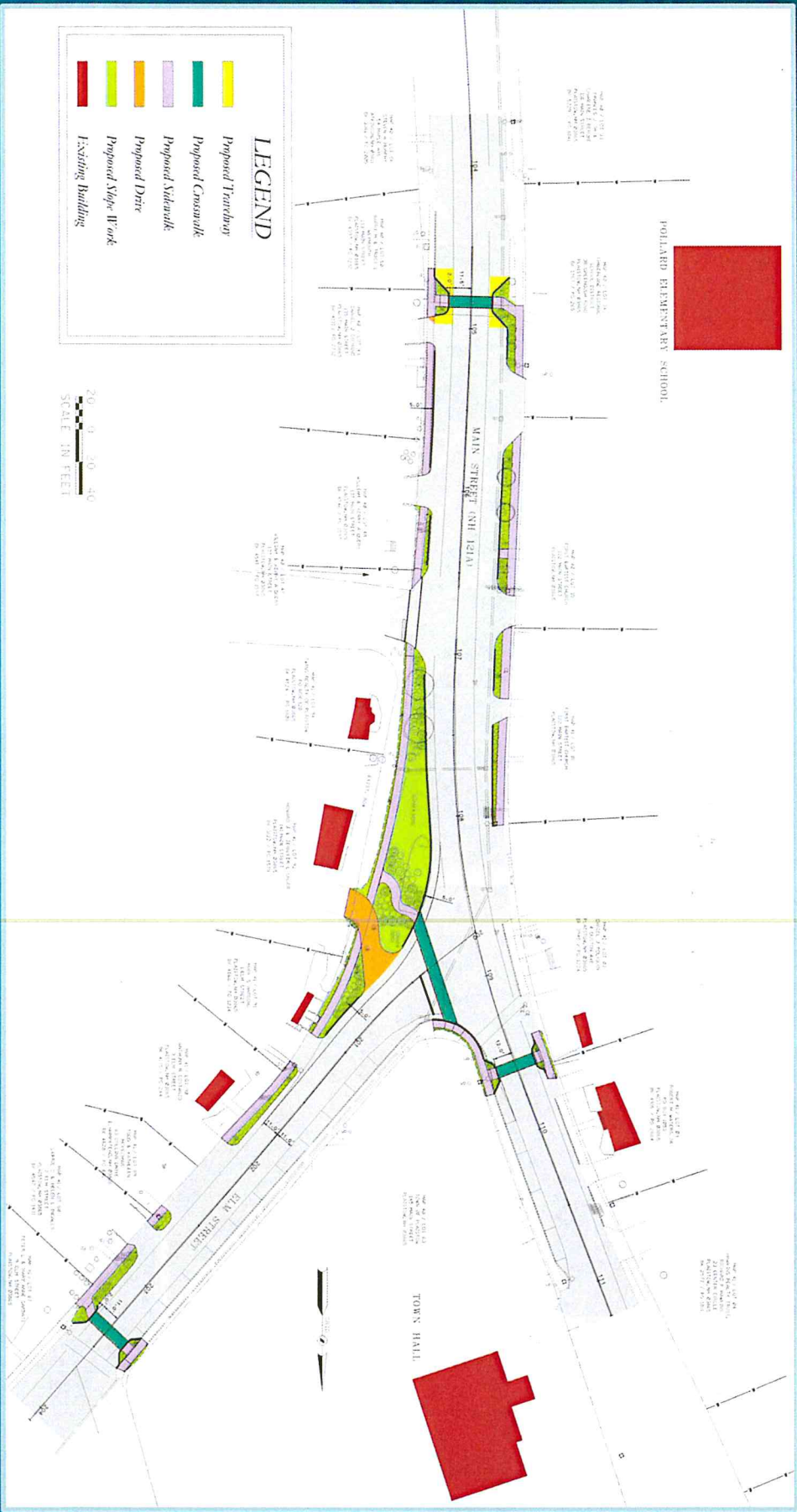

Figure 14:



Preferred Alternative



Preferred Alternative cont...

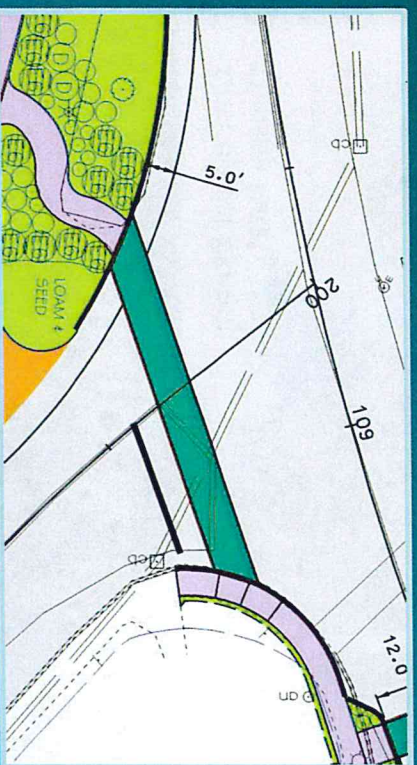
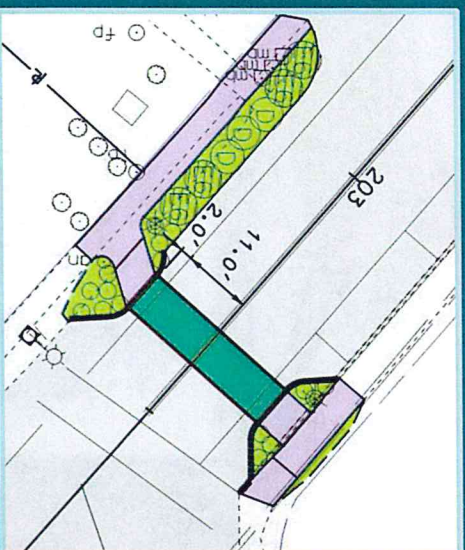
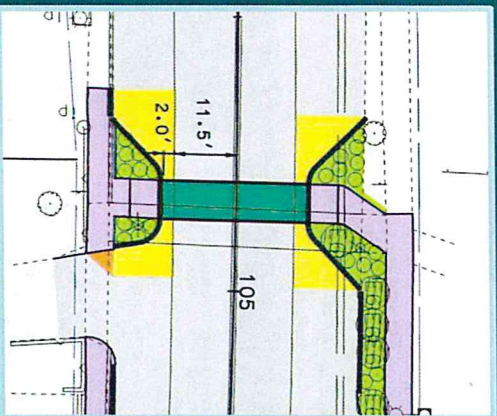

- Increased Visibility
- Reduced Crossing Width
- Anticipated Crossing Location
- ADA Compliant Sidewalk Widths
- Vertical Granite Curbing
- Enhanced Pedestrian Signage

Landscaping & Lighting

Conceptual Sketch "Trolley Park"

RECLAIM GREEN SPACE AT INTERSECTION
CREATES NODE FOR PEDESTRIANS SAFETY

PARK WITH INTERPRETIVE SIGN AND SECTION OF HISTORIC TROLLEY TRACK

PLANTINGS TO SOFTEN STREETSCAPE AND TREES TO PROMOTE TRAFFIC CALMING

PERIOD LIGHTING TO GIVE A NOD TO HISTORIC TROLLEY AND PROVIDE ADDITIONAL VERTICAL ELEMENTS NARROWING THE TRAVEL WAY TO PROMOTE TRAFFIC CALMING

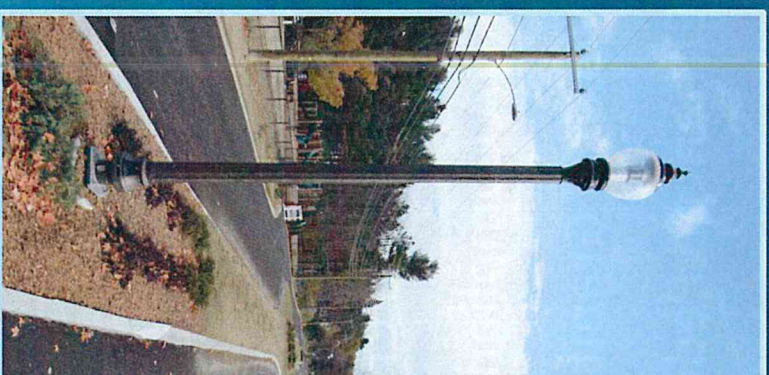
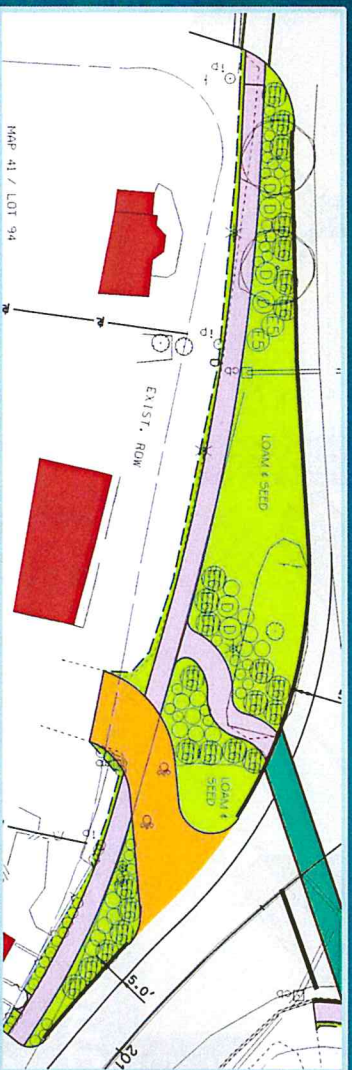

Hoyle, Tanner
& Associates, Inc.

Program Funding Requirements

- Safe Routes To School (SRTS) - LPA Program
- Reimbursement Program (100% of Participating Costs)
- \$240,000 from NHDOT
- Opportunities to Expand Project with Additional Grant Funding
- Estimated Construction Costs: \$225,000



U.S. Department of Transportation
**Federal Highway
Administration**

New Hampshire
DOT
Department of Transportation



Hoyle, Tanner
& Associates, Inc.

Project Schedule

NHDOT Project Manager: William Rose



Next Steps

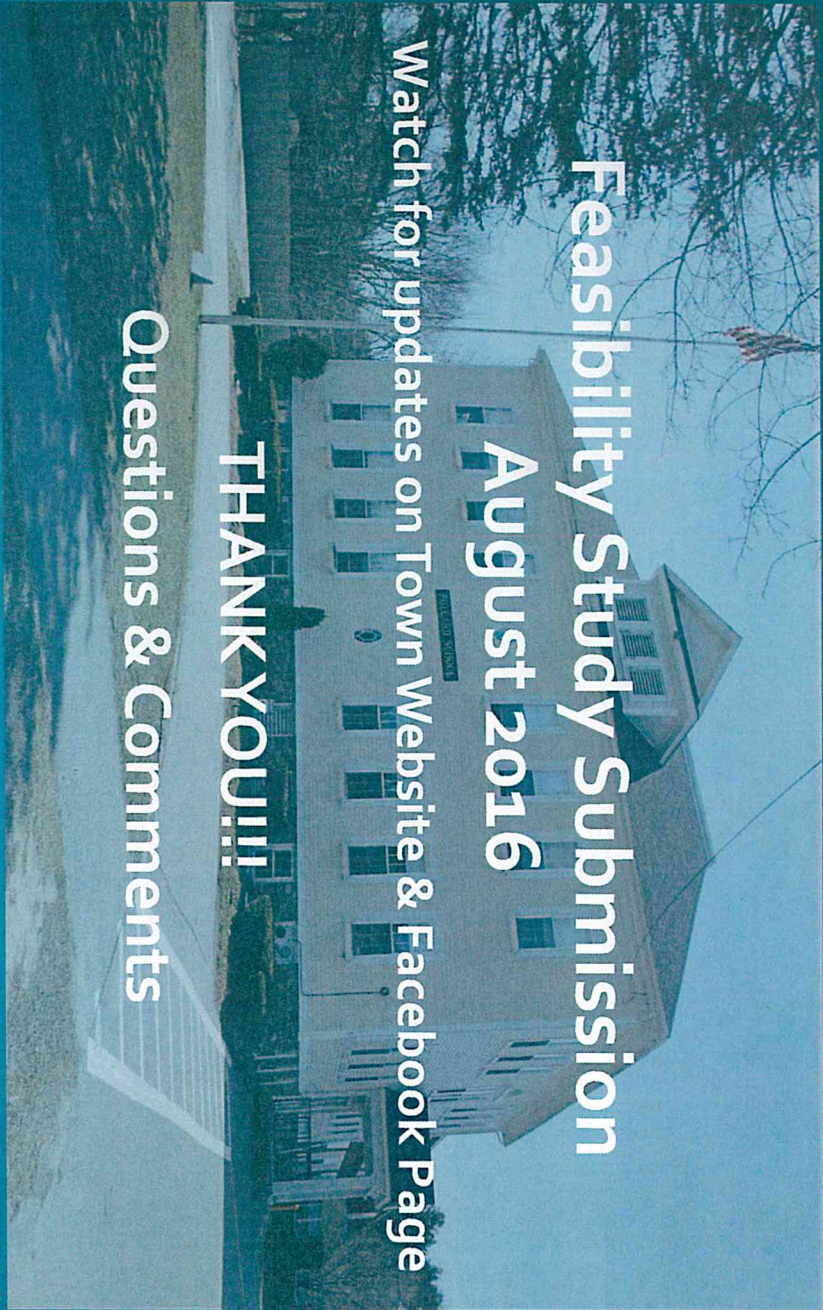

Feasibility Study Submission August 2016

Watch for updates on Town Website & Facebook Page

THANK YOU!!!

Questions & Comments

